

Combines side-attached units with apartments above or below. Can be used to achieve a mix of unit sizes, costs, and amenities.

common names
Stacked flats
Two-over-two
Maisonette

variations

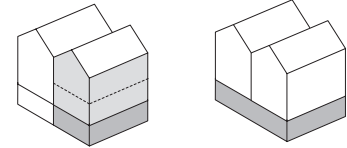

data
8-12 units/building
3-4 floors/building
interior or exterior entry
net site density:
25-40 units/acre

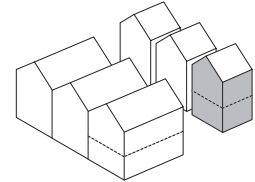

Home design

- Private and shared outdoor activities should be accommodated with elements such as stoops, balconies, terraces, and playgrounds.
- Increase in density begs more attention to privacy and territory, especially for sightlines and private outdoor space.
- Personalization is critical in distinguishing one unit from the next in what can be a rather uniform streetscape.

- Compact form with good access offers possibility for ecologically friendly site planning and land conservation.
- Parking demands attention—on street or surface is insufficient; structured increases cost per unit.

Site design

- Careful attention to sun and air access is more important as building bulk increases.

Neighborhood amenities

- Increase in units per acre can increase activity on both neighborhood and community scale streets
- Many options for ownership type, and unit modification, and multiple strategies for affordability.



Richfield, MN



Elliot Park, Minneapolis, MN



North Quadrant, St. Paul, MN



Golden Valley, MN



North Quadrant, St. Paul, MN



Warehouse District, Minneapolis, MN



Hennepin Avenue, Minneapolis, MN



Warehouse District, Minneapolis, MN



Lyndale Avenue, Minneapolis, MN